



Commercial

# WAREHOUSE AND 2 OFFICES IN MILL HILL NW7

## £2,500

### FEATURES

- Secure building with alarm
- Combination of different spaces available
- Shared use of kitchen
- Shared use of 2 x W.C.'s & shower
- Board Room/Meeting Room available (by agreement)
- Wi-fi, heating, electricity, water included



**SPACE**  
RESIDENTIAL

# 0 Bedroom Commercial located in Mill Hill

Space Residential as sole agents offer to rent via licence or lease 2 x Offices and warehouse/storage space in a modern building close to the centre of Mill Hill NW7.

The warehouse and 2 x offices available are located on the 1st floor of this secure building which is alarmed and available on either a renewable license or longer term lease (terms to be agreed).

There is parking available and the incoming tenants will also have use of a shared kitchen, 2 guest W.C's (1 with a shower).

There is a board room available which can be booked as required at no additional cost, and the space includes office furniture such as: desks, chairs, filing cabinets etc (details to be agreed as required), there is also Wi-Fi available and the rent will include heating, lighting, and water usage within the price.

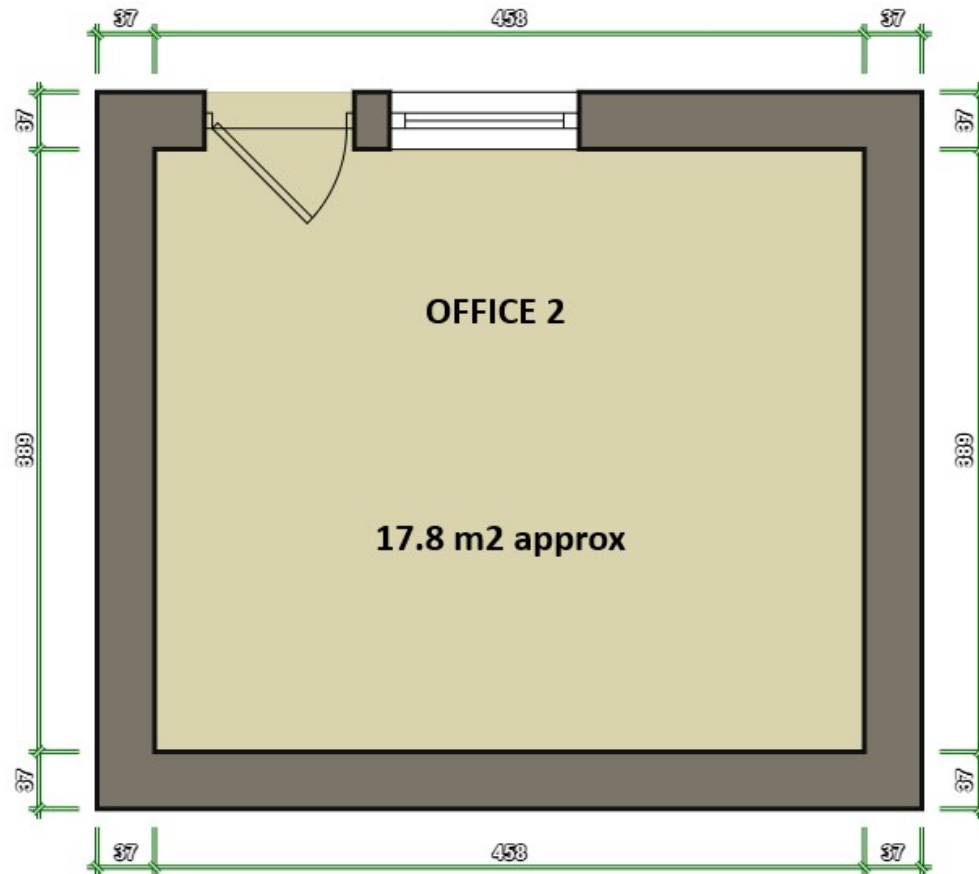

Call us on

**0208 906 2222**

[info@spaceresidential.com](mailto:info@spaceresidential.com)  
[spaceresidential.com](http://spaceresidential.com)

**Council Tax Band**

**Exempt**

Energy Efficiency Rating		Current	Potential
<i>Very energy efficient - lower running costs</i>			
(92 plus) <b>A</b>			
(81-91) <b>B</b>			
(69-80) <b>C</b>			
(55-68) <b>D</b>			
(39-54) <b>E</b>			
(21-38) <b>F</b>			
(1-20) <b>G</b>			
<i>Not energy efficient - higher running costs</i>			
<b>England &amp; Wales</b>		EU Directive 2002/91/EC	

Agents Note: Whilst every care has been taken to prepare these particulars, they are for guidance purposes only. All measurements are approximate and are for general guidance purposes only and whilst every care has been taken to ensure their accuracy, they should not be relied upon and potential buyers are advised to recheck the measurements.

